

US SERIES-Front Terminal

US12-180 FT (12V180AH)



General Features

- ◆ Sealed and maintenance free operation.
- ◆ Non-Spillable construction design.
- ◆ ABS containers and covers(UL94HB, UL94V-0) optional.
- ◆ Safety valve installation for explosion proof.
- ◆ High quality and high reliability.
- ◆ Exceptional deep discharge recovery performance.
- ◆ Low self discharge characteristic.
- ◆ Flexibility design for multiple install positions.



Battery Type	Valve-Regulated,Absorbed Glass Mat(AGM) Technology			
Nominal Voltage	12V			
Capacity(20°C)	20HR(8.75A,1.8V/cell)	10HR(16.5A,1.80V)	5HR(29.7A,1.75V)	1HR(108.9A,1.60V)
	175.0AH	165.0AH	148.5AH	108.9AH
Dimensions	Length	Width	Height	Total Height
	560mm(22.05inches)	126mm(4.96inches)	280mm(11.02inches)	280mm(11.02inches)
Approx Weight	Approx 54.0 kg (119.1lbs)			
Internal Resistance	Full Charged at 20°C: Approx 2.9m Ω			
Self Discharge	3% of capacity declined per month at 20°C			
Capacity affected by Temperature (10HR)	40°C	25°C	0°C	-15°C
	103%	100%	86%	65%
Charging Voltage (V)	Cycle use		Float use	
	14.4V~15.0V at 20 °C. T emp. Coefficient -30mV/ °C		13.5V~13.8V at 20 °C.Temp. Coefficient (-20mV/ °C)	
Current	Max. Discharge Current		Initial Charging Current	
	1360A		Less than 54.0A	
Operating T emp.Range	Discharge		Charging	
	-15 ~50°C (5 ~122°F)		0 ~40°C (32 ~104°F)	
	Storage			
			-15 ~40°C (5 ~104°F)	

Constant Current Discharge (A mperes) at 20 °C (68 °F)

F.V/Time	10min	15min	20min	30min	45min	1h	2h	3h	4h	5h	6h	8h	10h	20h
1.85V/cell	270.9	225.8	193.8	152.0	117.9	96.8	57.8	41.5	33.4	27.7	24.3	18.9	15.8	8.36
1.80V/cell	307.1	251.7	214.5	166.3	126.8	103.4	60.9	44.2	35.1	29.1	25.6	19.9	16.5	8.74
1.75V/cell	337.0	272.3	228.9	174.8	131.6	107.0	62.1	45.0	36.0	29.7	25.9	20.1	16.7	8.88
1.70V/cell	360.5	286.8	238.1	179.9	134.7	108.4	62.9	45.4	36.3	29.9	26.2	20.4	16.9	8.94
1.67V/cell	373.1	294.0	243.1	182.1	135.1	108.9	63.1	45.6	36.5	30.2	26.6	20.7	17.0	8.99
1.60V/cell	\	305.3	253.9	186.7	138.7	111.8	64.2	46.6	37.3	31.0	27.0	21.2	17.3	9.03

Constant Power Discharge (Watts) at 20 °C (68 °F)

F.V/Time	10min	15min	20min	30min	45min	1h	2h	3h	4h	5h	6h	8h	10h	20h
1.85V/cell	505.9	425.9	369.1	292.7	228.9	188.7	113.2	81.9	65.9	54.8	48.3	37.7	31.5	16.8
1.80V/cell	566.8	468.3	402.7	315.5	244.3	200.4	118.7	86.7	69.0	57.3	50.5	39.6	33.0	17.5
1.75V/cell	612.1	500.7	425.6	328.8	251.3	206.5	120.5	87.7	70.5	58.4	51.1	39.9	33.3	17.7
1.70V/cell	640.2	520.1	439.5	336.5	256.2	208.6	121.9	88.4	70.8	58.6	51.7	40.4	33.6	17.9
1.67V/cell	659.8	530.8	446.7	340.1	256.2	209.0	122.1	88.7	71.3	59.1	52.1	41.0	33.8	17.9
1.60V/cell	\	540.3	460.1	344.2	260.2	212.3	123.1	89.9	72.4	60.4	53.0	41.8	34.4	18.0

Dimensions

T13 Terminal Unit: mm [inches]

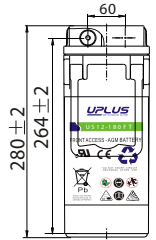
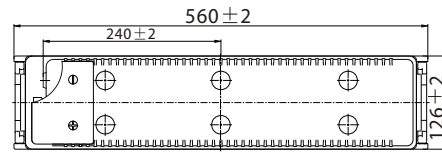
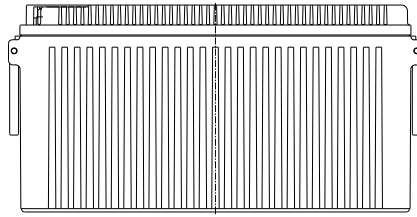
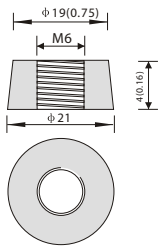

Torque: 3.9~5.4N*M

Float charging characteristics

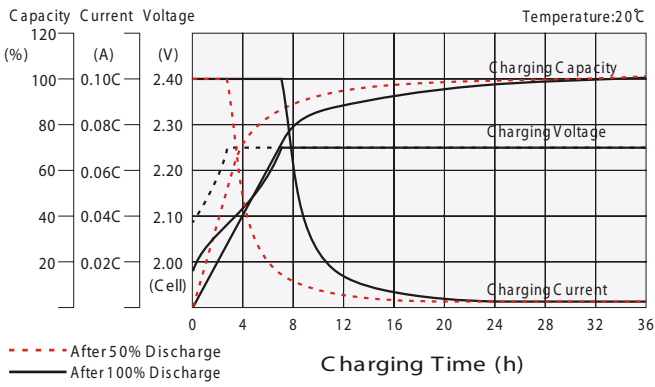

Cycle use charging characteristics

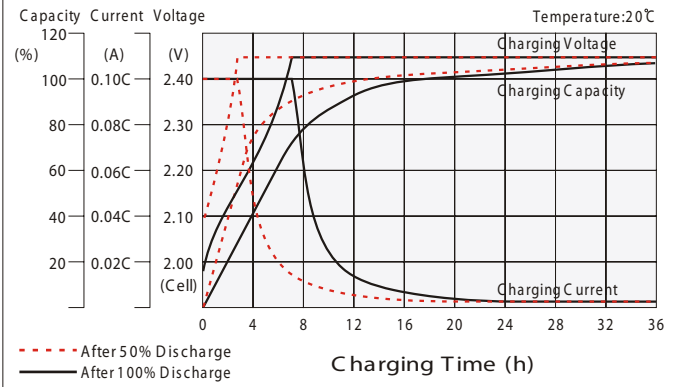

Effect of Temperature on Long Term Float Life

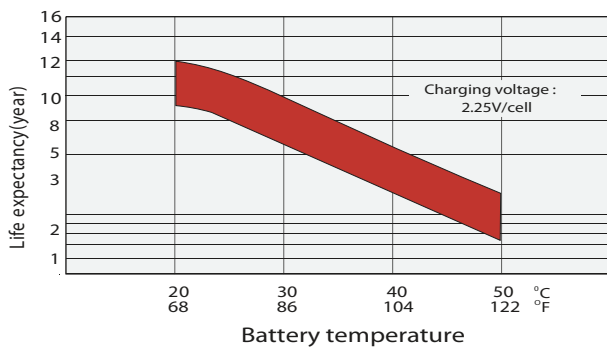

Discharge characteristics

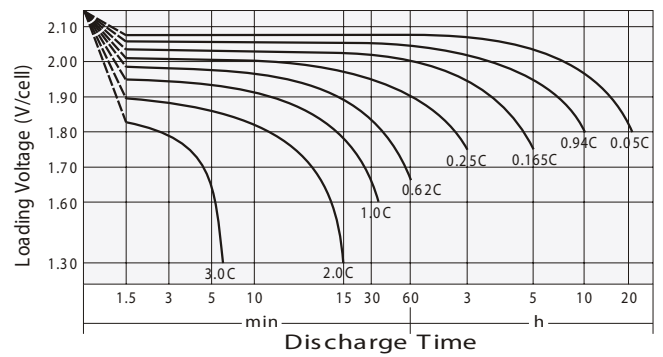

Cycle Life in Relation to Depth of Discharge

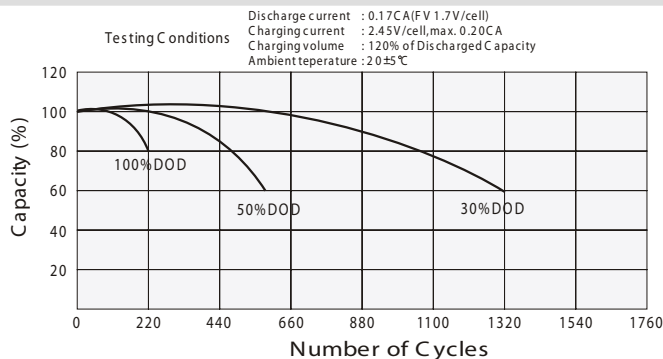

Self Discharge Characteristics

